

WN 055393 45532
10/04

CE	DORMA GmbH + Co. KG		04	
	Postfach 4009 58 247 Ennepetal			
0432 - BPR 0009	EN 1154:1996+A1:2002	3 8	2-4 1 1 4	3 8
Dangerous substances: None		3 8	3-6 1 1 4	

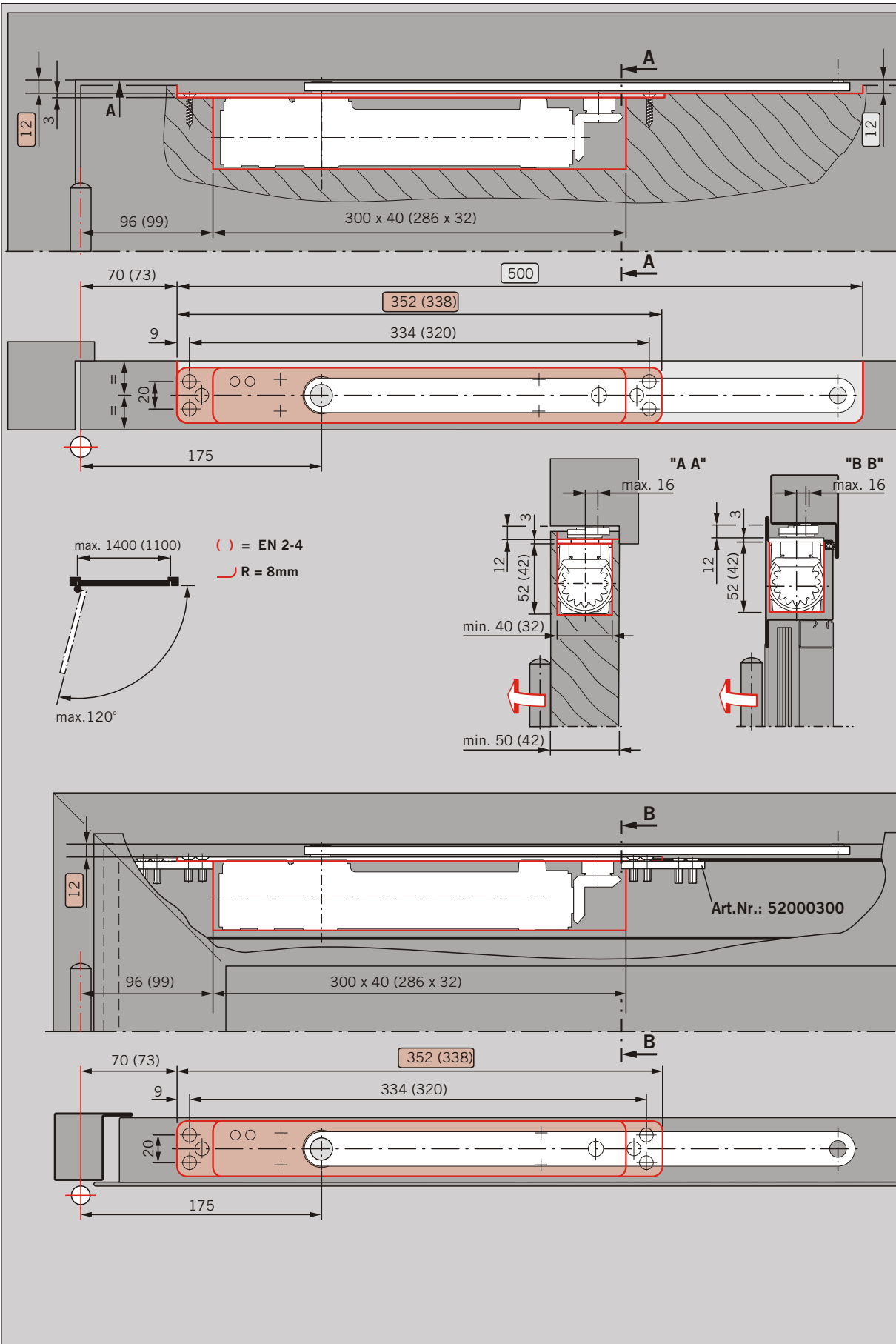

Änderungen vorbehalten
Subject to change without notice